

FORM No. 1.

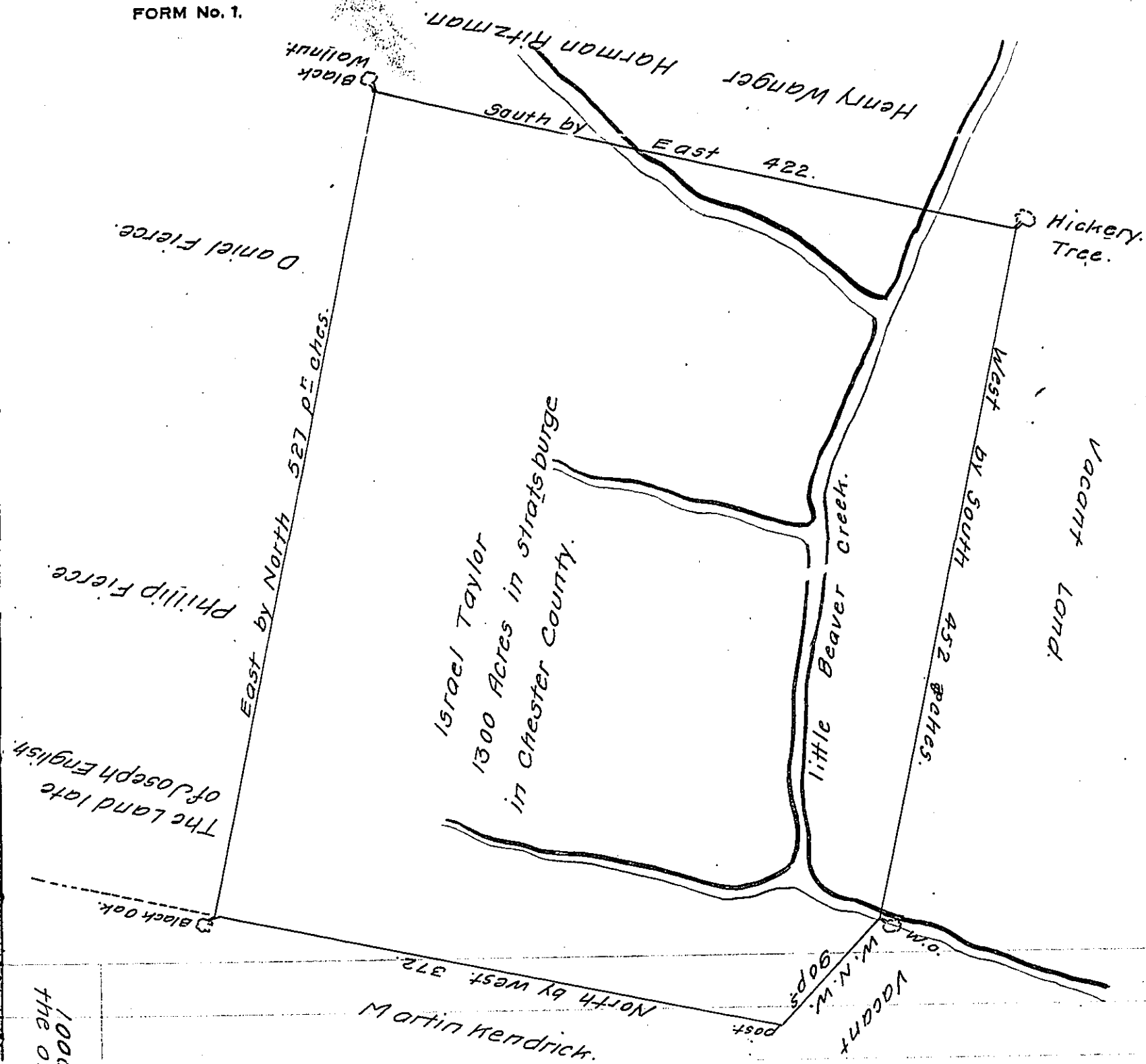

1000 Acres of This Land Surveyd May 14<sup>th</sup> 1719  
 the other 300 Acre ye 20<sup>th</sup> 1720 p<sup>er</sup> 15. Taylor.

Beginning at a Corner Marked Black Oak standing in the Line of Martin Kendrick thence East by North by the Land Late of Joseph English and by the Land of Phillip Fierce & Daniel fierce 527 perches to a Black Walnut Tree thence S<sup>o</sup> by East by the Land of Harman Ritzman and Henry Wauger 422 perches to a Hickery Tree thence West by So. by vacant Land 452 perches to a White oak by little Beaver Creek thence W.N.W. by Vacant Land 90 p<sup>er</sup>ches to a post thence North by west by ye Land of ye s<sup>d</sup> Martin Kendrick 372 perches to ye place of Beginning Containing 1300 Acres with ye usual allowance of 6 p<sup>er</sup> Cent.

IN TESTIMONY that the above is a copy of the original remaining on file in the Department of Internal Affairs of Pennsylvania, made conformably to an Act of Assembly approved the 16th day of February, 1833, I have hereunto set my Hand and caused the Seal of said Department to be affixed at Harrisburg, this thirty first day of May, 1910.

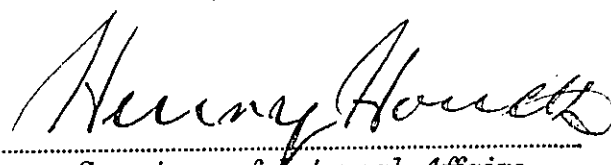
  
 Secretary of Internal Affairs.